



**atlas megasteel**

**STEEL SHELVING**



Atlas Mega Steel manufactures the highest quality, full-line assortment of material handling and storage equipment in the industry. Our products combine years of proven engineering with the latest technology and supply chain practices. With manufacturing plants strategically located throughout the world, we can provide the right solution for every storage application. By maintaining a strong economic focus along with our commitment to the most stringent quality standards, Atlas Mega Steel is your complete global storage solution.

## STEEL SHELVING



- Light weight and easy to assemble.
- Powder coat finish.
- Adjustable steel flange shelves.
- Boxer (box shelf) adjustable steel box shelves are available.
- All 4 corners are lapped and welded for additional strength.

For decades, Steel Shelving has been the standard for inventory and parts storage within the warehousing industry. Their clean appearance and excellent load capacities make it the primary choice within light duty applications for automotive, aviation and other highly regulated industries. All materials are given a rust resistant treatment before the powder-coat finish is applied and baked it. Our Steel Shelving provides lasting durability with an outstanding appearance.

## ADVANTAGES

- Open shelf units use sway bracing.
- Closed shelf units use backs and sides.
- A wide range shelving sizes.
- Standard color is dark gray, also available in other colors, mist gray, dove grey, sand, blue, tan, putty, red, black and pearl white.
- Shelving units are available in 18, 20, and 22 gauge steel.
- Upright posts sizes vary from 3ft high - 16ft high.
- Light duty warehouse shelving.
- Auto parts storage shelving systems.

# FLANGE & BOX SHELVES

## ADJUSTABLE STEEL FLANGE SHELVES (FOR CLIP-TYPE AND NUT AND BOLT)

All shelves are made of 20 or 18 gauge cold rolled steel.

Each side has triple bends for added strength.

**NOTE:** ADD SUFFIX X FOR 18 GAUGE

**EXAMPLE:** S924X = 18 GAUGE 9" x 24"



Model Number	Size	20 GA. Wt.	18 GA. Wt.
S924	9" x 24"	3.8	5.3
S930	9" x 30"	4.8	6.3
S936	9" x 36"	5.0	7.3
S942	9" x 42"	6.9	8.3
S948	9" x 48"	8.9	9.3
S1224	12" x 24"	4.9	6.4
S1230	12" x 30"	5.0	6.7
S1236	12" x 36"	6.5	8.0
S1242	12" x 42"	8.0	10.3
S1248	12" x 48"	9.0	11.6
S1524	15" x 24"	5.9	7.5
S1530	15" x 30"	6.1	9.0
S1536	15" x 36"	7.1	10.5
S1542	15" x 42"	8.2	12.0
S1548	15" x 48"	9.5	13.5
S1824	18" x 24"	6.9	8.7
S1830	18" x 30"	7.0	10.4
S1836	18" x 36"	8.2	12.1
S1842	18" x 42"	9.5	13.8
S1848	18" x 48"	10.7	15.5
S2124	21" x 24"	8.7	10.0
S2130	21" x 30"	8.9	11.3
S2136	21" x 36"	10.5	14.6
S2142	21" x 42"	12.1	16.9
S2148	21" x 48"	13.7	19.2
S2424	24" x 24"	9.0	11.0
S2430	24" x 30"	9.3	13.3
S2436	24" x 36"	11.0	15.6
S2442	24" x 42"	11.9	17.9
S2448	24" x 48"	13.9	20.2
S3030	30" x 30"	13.0	16.6
S3036	30" x 36"	13.5	18.8
S3042	30" x 42"	14.0	21.6
S3048	30" x 48"	17.5	24.4
S3636	36" x 36"	16.0	22.1
S3642	36" x 42"	18.4	25.4
S3648	36" x 48"	19.5	28.6





# SHELVING POST



## OFFSET ANGLE POST 1-1/2" O.C.

Made of 14 gauge cold-rolled steel, roll formed into a 1"x 1-7/8" angle. The wide flange is punched on 1-1/2" centers with 7/16" square slots to receive shelf clips and 5/16" diameter holes on 1-1/2" centers for the attachment of side sway braces or solid panels.

Model Number	Size	Wt.
OP37	3'1"	2.0
OP49	4'1"	3.0
OP61	5'1"	4.0
OP73	6'1"	4.8
OP85	7'1"	5.5
OP97	8'1"	6.0
OP109	9'1"	7.0
OP121	10'1"	8.0
OP133	11'1"	8.8
OP145	12'1"	9.5

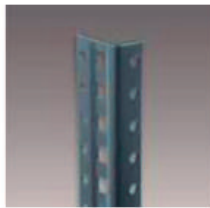

## OFFSET ANGLE POST 1" O.C.

Made of 14 gauge cold-rolled steel, roll formed into a 1"x 1-7/8" angle. The wide flange is punched on 1" centers with 7/16" square slots to receive shelf clips and 5/16" diameter slots to receive side sway braces or solid panels.

Model Number	Size	Wt.
OP39	3'3"	2.0
OP51	4'3"	3.0
OP63	5'3"	4.0
OP75	6'3"	4.8
OP87	7'3"	5.5
OP99	8'3"	6.0
OP111	9'3"	7.0
OP123	10'3"	8.0
OP135	11'3"	8.8

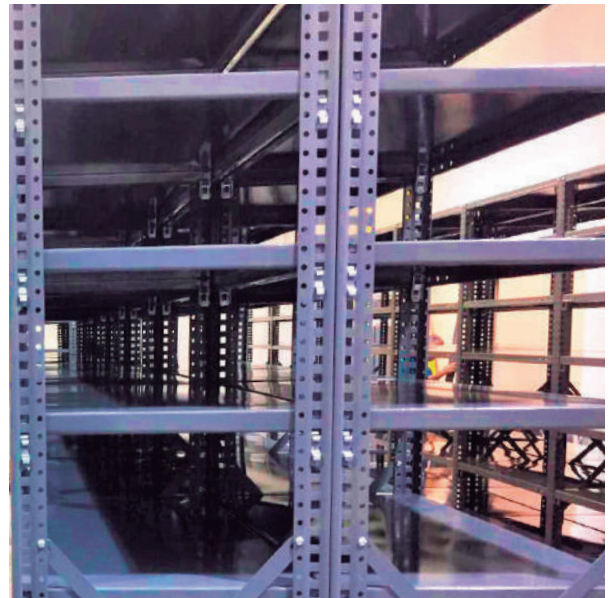

# SWAY BRACES, REINFORCEMENTS, SHELVING CLIPS & HARDWARE



## SWAY BRACES

Made of 1" wide hot-rolled 12 gauge steel strip with safety edges. Ends are radiused and punched for attaching to front a rear post.

Model Number	Shelf Size	Wt.
SB18	12"-18"	1.0
SB36	24"-36"	2.0
SB48	42"-48"	3.2

## GENERAL SIDE/BACK & SWAY BRACE INFO:

When supplying open shelving units, one pair of braces for each side/back location may not always be sufficient. The following is our recommended sway brace to unit height chart.  
**NOTE:** Common sides and backs share sway bracing.

Post height up to 7'	1 pair of sway braces for each side/back location
Post height from 8' to 10'	2 pair of sway braces for each side/back location
Post height from 11' to 13'	3 pair of sway braces for each side/back location
Post height from 14' to 16'	4 pair of sway braces for each side/back location

## CLIPS FOR OFFSET/BOX POSTS

14 gauge (.078 thick) steel zinc plated.

Model Number	Wt.
COP15	1 oz.
COP1	1 oz.



## REINFORCEMENTS

A 1" x 1" angle made of 12 gauge steel used to reinforce front and /or back of shelf.

Model Number	Size	Wt.
RB18	18"	7
RB21	21"	1.0
RB24	24"	1.4
RB30	30"	1.7
RB36	36"	2.0
RB42	42"	2.4
RB48	48"	2.7



## ROUNDHEAD BOLTS WITH HEX NUTS

(Sold in boxes of 100)

Model Number	Size	Quantity	Wt.
HB63	1/4" x 5/8"	100	2
HB100	1/4" X 1"	100	2.5
HB125	1/4" X 1-1/4"	100	3



1-1/2" O.C. (COP15) 1" O.C. (COP1)

# ANGLE SWAYS & SPLICES

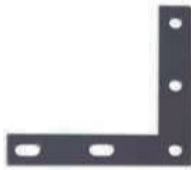

## ANGLE SWAYS (For 1" on Center Offset and Nut & Bolt Shelving)

A 5" x 5" L-shaped bracket that is made of 11 gauge steel with holes punched 2" on center.

Gives 5 points of fastening between shelf and upright to prevent lateral movement when sway bracing is not used.

Model Number	Size	Wt.
AN55	5" x 5"	.02



## OFFSET ANGLE SWAYS (For 1-1/2" on Center Shelving)

A 5" x 5" L-shaped bracket made of 11 gauge steel with one leg punched on 2" centers and the other punched 1-1/2" on center. Gives 5 points of fastening between shelf and upright to prevent lateral movement when sway bracing is not used.

Model Number	Size	Wt.
OAS55	5" x 5"	.2



# SLOTTED ANGLE COMPONENTS & SPECIFICATIONS

## 14 GAUGE – FOR AVERAGE JOBS COLD-ROLLED HIGH STRENGTH STEEL RECOMMENDED WHEN EXTREME LOADS ARE NOT REQUIRED.

- Nominal size 1-1/2" x 1-1/2" and 1-1/2" x 2-1/2".
- Available in 8', 10' and 12' lengths, painted or galvanized.
- Packaged 10 pieces per bundle.

Painted Model No.	Galvanized Model No.	Gauge	Size	Pieces Per Bundle
SA15158	SA15158GAL	14	1-1/2" x 1-1/2" x 8'	10
SA151510	SA151510GAL	14	1-1/2" x 1-1/2" x 10'	10
SA151512	SA151512GAL	14	1-1/2" x 1-1/2" x 12'	10
SA25158	SA25158GAL	14	1-1/2" x 2-1/2" x 8'	10
SA251510	SA251510GAL	14	1-1/2" x 2-1/2" x 10'	10
SA251512	SA251512GAL	14	1-1/2" x 2-1/2" x 12'	10

## 12 Gauge – For Heavy Duty Jobs HEAVIER WEIGHT COLD-ROLLED HIGH STRENGTH STEEL – RECOMMENDED FOR USE WHEN GREATER STRENGTH AND CARRYING CAPACITY IS REQUIRED.

- Nominal size 1-1/2" x 1-1/2" and 1-1/2" x 2-1/2".
- Available in 8', 10' and 12' lengths, painted or galvanized.
- Packaged 10 pieces per bundle.

Painted Model No.	Galvanized Model No.	Gauge	Size	Pieces Per Bundle
SA30158	SA30158GAL	12	1-1/2" x 3" x 8'	10
SA301510	SA301510GAL	12	1-1/2" x 3" x 10'	10
SA301512	SA301512GAL	12	1-1/2" x 3" x 12'	10



1-1/2" x 1-1/2" x 10' 0"



2-1/2" x 1-1/2" x 10' 0"



3" x 1-1/2" x 10' 0"



# SLOTTED ANGLE COMPONENTS & SPECIFICATIONS

## LOAD CAPACITIES WHEN SLOTTED ANGLE IS USED AS BEAMS (HORIZONTAL MEMBERS) IN POUNDS EACH SECTION.

Combination sections are bolted together on 6" centers. Capacities T-Section based on uniformly Loading Direction Single Beam Single Beam Wide T-Section T-Section distributed load. For concentrated loads, use half these figures.

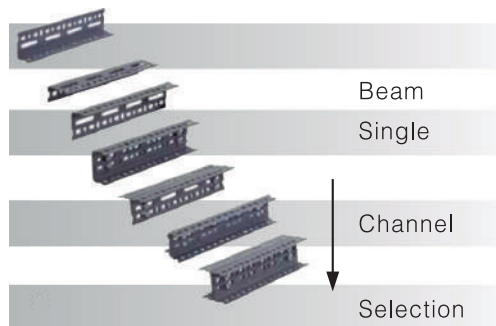

## SPAN

Size	GA	3 FT	4 FT	5 FT	6 FT	7 FT	8 FT	9 FT	10 FT
1 1/2" X 2 1/4"	14	331	230	—	—	—	—	—	—
1 1/2" X 3"	12	621	450	362	—	—	—	—	—
1 1/2" X 2 1/4"	14	441	316	210	—	—	—	—	—
1 1/2" X 3"	12	590	421	294	197	—	—	—	—
1 1/2" X 2 1/4"	14	772	527	397	306	235	173	—	—
1 1/2" X 3"	12	1,400	909	631	499	374	270	212	—
1 1/2" X 2 1/4"	14	1,418	1,070	761	613	466	362	284	257
1 1/2" X 3"	12	2,799	2,061	1,540	1,236	970	762	567	430
1 1/2" X 2 1/4"	14	1,860	1,365	1,018	806	657	540	455	352
1 1/2" X 3"	12	3,735	2,664	2,064	1,704	1,413	1,161	951	777
1 1/2" X 2 1/4"	14	2,621	1,884	1,491	1,227	1,022	851	727	633
1 1/2" X 3"	12	4,707	3,615	2,917	2,430	2,048	1,765	1,546	1,386
1 1/2" X 2 1/4"	14	3,146	2,232	1,799	1,477	1,266	1,119	1,004	900
1 1/2" X 3"	12	5,850	4,538	3,621	3,096	2,705	2,352	2,073	1,812

## LOAD CAPACITIES WHEN SLOTTED ANGLE IS USED AS UPRIGHTS (VERTICAL POSTS) IN POUNDS EACH SECTION.

To determine safe allowable load per column, use longest vertical space between horizontal braces.

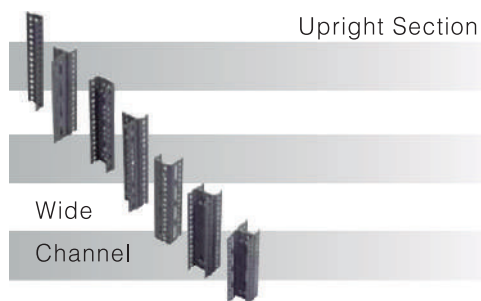

## HEIGHT

Size	GA	3 FT	4 FT	5 FT	6 FT	7 FT	8 FT	9 FT	10 FT
1 1/2" X 2 1/4"	14	2,302	1,899	1,526	1,188	806	—	—	—
1 1/2" X 3"	12	3,308	2,775	2,165	1,1602	1,251	900	—	—
1 1/2" X 2 1/4"	14	4,917	4,527	3,974	3,342	2,739	2,385	2,208	—
1 1/2" X 3"	12	7,482	6,807	6,080	5,214	4,235	3,396	3,317	2,214
1 1/2" X 2 1/4"	14	5,139	4,860	4,505	4,091	3,623	3,096	2,587	2,129
1 1/2" X 3"	12	8,069	7,734	7,329	6,897	5,871	5,277	4,622	3,902
1 1/2" X 2 1/4"	14	9,849	9,021	7,965	6,683	5,486	4,770	4,419	4,140
1 1/2" X 3"	12	14,963	13,622	12,168	10,434	8,481	6,795	6,273	4,428
1 1/2" X 2 1/4"	14	10,269	9,707	9,009	8,168	7,250	6,174	5,171	4,253
1 1/2" X 3"	12	16,565	15,998	15,237	14,382	13,062	12,254	11,012	9,567

**NOTE:** CAUTION: All loads given are based on uniform loading. Consideration must be given to concentrated loads, shock loads and methods using material handling.



**RIVET SHELVING**



**DRIVE-IN RACKING**

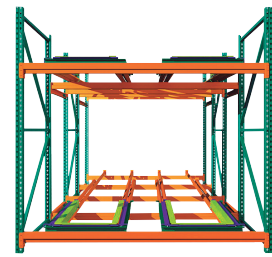

**PUSH BACK RACKING**



**ROLLING LADDERS**



**PALLET RACK**

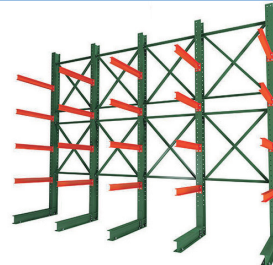

**CANTILEVER RACKING**

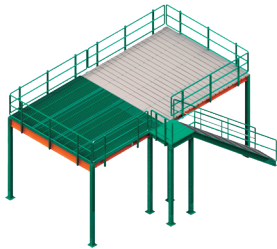

**MEZZANINES**



**PALLET JACK**



**LOCKERS**

Also available from



tel. 305-556-2222  
7525 West 20th Ave  
Hialeah, FL 33014 USA  
[www.atlasmegasteel.com](http://www.atlasmegasteel.com)

